

Donaldson
Torit®



DOWNDRAFT BENCH

MODELS DB-2000 AND DB-3000

ULTRA-WEB®
High Efficiency **Fine Fiber Filters** Built to Last



Self-contained dust collector bench used in grinding and finishing operations.

- Powerful downward airflow effectively captures dust and fume
- Even air distribution provides effective dust control over the entire work surface
- Hinged side-wing panels open to accommodate longer workpieces
- Built-in fluorescent light illuminates work area
- Ergonomically designed for operator comfort
- Fibra-Web® FR filter cartridges featuring fine fiber technology provide high filtration efficiency and long filter life
- MERV* 14 filtration efficiency rating per ASHRAE 52.2-2007
- Provides a cleaner work environment for maximum productivity
- Helps support OSHA Clean Air Standards
- Quiet operation

DIMENSIONS & SPECIFICATIONS

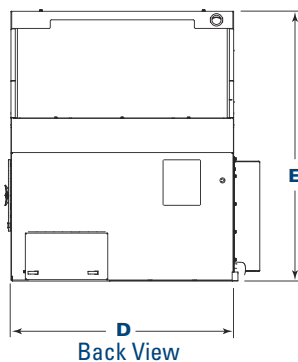
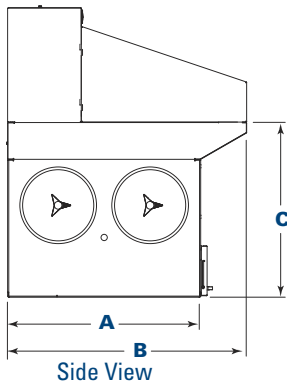

| Model | Dimensions | | | | | | | | | | Shipping Weight | |
|---------|------------|--------|------|--------|------|-------|------|--------|------|--------|-----------------|-------|
| | A | | B | | C | | D | | E | | lb | kg |
| | in | mm | in | mm | in | mm | in | mm | in | mm | | |
| DB-2000 | 42.0 | 1066.8 | 52.0 | 1320.8 | 38.0 | 965.2 | 52.0 | 1320.8 | 63.0 | 1600.2 | 980 | 444.5 |
| DB-3000 | 42.0 | 1066.8 | 52.0 | 1320.8 | 38.0 | 965.2 | 78.0 | 1981.2 | 63.0 | 1600.2 | 1300 | 589.7 |

| Model | Nominal Airflow** | | Filter Area | | Motor (hp) | Downdraft Velocity | | Dust Capacity | | Max Load | | Sound Level dB(A)† |
|---------|-------------------|------|-------------|-------------|------------|--------------------|-------|---------------|------|----------|--------|--------------------|
| | cfm | m³/h | ft² | m² | | fpm | m/min | ft³ | m³ | lb/ft² | kg/m² | |
| DB-2000 | 2000 | 3397 | 240 - 508 | 22.3 - 47.2 | 3 | 200 | 61.0 | 1.4 | 0.04 | 75 | 1201.4 | 68 |
| DB-3000 | 3000 | 5096 | 480 - 1016 | 44.6 - 94.4 | 5 | 200 | 61.0 | 2.8 | 0.08 | 75 | 1201.4 | 72 |

Note: Customer must have 90 to 100 psi clean air available. Filter area depends on the type of cartridge used.

STANDARD FEATURES & AVAILABLE OPTIONS

| STANDARD | OPTIONAL |
|---|--|
| Heavy-duty work surface supports 75 lb/ft² (1201.4 kg/m²) | Prewired controls with after-shift cleaning system |
| Automatic self-cleaning pulse jet system | Scratch-resistant work surfaces |
| Quiet, efficient backward inclined airfoil fan | Variety of Torit-Built® filter cartridges |
| Large capacity dust drawers | <p>* The Minimum Efficiency Reporting Value (MERV) of this filter cartridge has been determined through independent laboratory testing using ASHRAE 52.2 (2007) test standards. The MERV rating was determined at a face velocity of 118 feet (36.0 meters) per minute and loading up to four inches (101.6 millimeters) water gauge. Actual efficiency of any filter cartridge will vary according to the specific application parameters. Dust concentration, airflow, particle characteristics, and pulse cleaning methods all affect filtration efficiency.</p> <p>** Based on clean filters.</p> <p>† Sound level per ANSI S12.34.1988. The actual measured sound level will vary, depending on background noise and room conditions.</p> |
| Fibra-Web® FR cartridge | |
| Fluorescent light fixture | |
| 10-year warranty | |

Important Notice

Many factors beyond the control of Donaldson can affect the use and performance of Donaldson products in a particular application, including the conditions under which the product is used. Since these factors are uniquely within the user's knowledge and control, it is essential the user evaluate the products to determine whether the product is fit for the particular purpose and suitable for the user's application. All products, product specifications, availability and data are subject to change without notice, and may vary by region or country.

